

# GAMA PRODUCTO

## PRODUCT RANGE

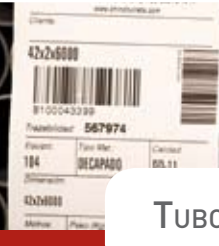

### TUBO REDONDO | CIRCULAR TUBE

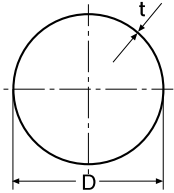

Peso teórico kg / metro  
Theoretical weight kg / meter

Diámetro exterior especificado D con intervalos de tolerancia <i>Specified outside diameter D with tolerance intervals</i>		Espesor de pared t / <i>t wall thickness</i>				
		1,5	2	2,5	3	4
16	±0,12	0,536	0,690			
18		0,610	0,789			
19		0,647	0,838			
20	±0,15	0,684	0,887			
22		0,758	0,986			
25		0,869	1,134	1,387	1,627	
26		0,906	1,183	1,448	1,701	
28		0,980	1,282	1,572	1,849	
30		1,054	1,380	1,695	2,000	
32	±0,20	1,128	1,479	1,820	2,145	
35		1,239	1,627	2,003	2,367	
38		1,350	1,775	2,188	2,589	
40		1,424	1,873	2,312	2,737	3,551
42		1,497	1,972	2,435	2,885	3,750
42,4		1,513	1,992	2,460	2,914	3,787
44	±0,25	1,572	2,071	2,558	3,033	3,940
45		1,608	2,120	2,620	3,107	4,044
48,3		1,719	2,366	2,820	3,350	4,370
50		1,793	2,366	2,928	3,477	4,540
51		1,831	2,416	2,990	3,551	4,660
55	±0,30	1,978	2,613	3,236	3,847	5,030
57		2,052	2,712	3,360	3,995	5,230
60		2,163	2,859	3,545	4,217	5,550
63,5		2,293	3,033	3,760	4,475	5,910
70	±0,35	2,533	3,352	4,161	4,960	6,510
75		2,718	3,599	4,469	5,326	7,003
76		2,755	3,648	4,531	5,400	7,110

### TUBO REDONDO | CIRCULAR TUBE

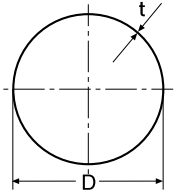

Peso teórico kg / metro  
Theoretical weight kg / meter

Diámetro exterior especificado D con intervalos de tolerancia <i>Specified outside diameter D with tolerance intervals</i>		Espesor de pared t / <i>t wall thickness</i>				
		1,5	2	2,5	3	4
80	±0,40	2,903	3,845	4,777	5,700	7,500
89		3,235	4,289	5,332	6,360	8,383
90		3,272	4,338	5,394	6,440	8,480
100	±0,50	3,642	4,831	6,010	7,180	9,470
101,6			4,912	6,109	7,290	9,630
108	±0,60		5,226	6,503	7,770	10,260
114			5,538	6,870	8,230	10,880
120			5,817	7,243	8,660	11,440
125			6,064	7,551	9,030	11,940
127	±0,80		6,163	7,674	9,170	12,130
133			6,458	8,044	9,620	12,730
139,7			6,840	8,414	10,110	13,390
152,4	±1		7,470	9,240	11,080	14,710
159			7,740	9,647	11,540	15,290
168			8,184	10,20	12,230	16,210
177,8				10,80	12,930	17,140
193,7				11,78	14,110	18,710

